



X Light

Subsea Bright Deepwater 24Vdc LED Panel Floodlight

The Teledyne Bowtech 6000m rated X Light is a bright 10,000 lumens, 24Vdc, subsea LED panel floodlight, emitting 10,000 lumens ideal for use on larger lower-powered, deepwater vehicles such as trenchers, tractors, and work class ROVs.

Housed in hard anodised aluminium, the X Light has a diameter of 103mm, a length of 132mm, and a width of 57.6mm (excluding connector) and is offered with a choice of connectors and wiring configurations.

The X Light has a selection of controls, including normal ON / OFF power switching and dimming controls via either remote analogue voltage control or 'Remote active dimming control' through the Teledyne Bowtech browser (supplied on a USB stick) via an RS-485 interface.

If you are unsure of the correct specification when ordering these lights, please contact a member of our sales team to discuss your preferred lumens output, connector and wiring configuration.



Application: work class ROV

PRODUCT FEATURES AND BENEFITS

- Low-power 24Vdc LED panel light
- Very bright 10,000 lumens output
- Choice of remote-control options
- High-quality durable anodised aluminium 6000m rated housing
- For mid and deepwater vehicles, such as trenchers, tractors, and work class ROVs
- Ideal for a wide range of subsea operations

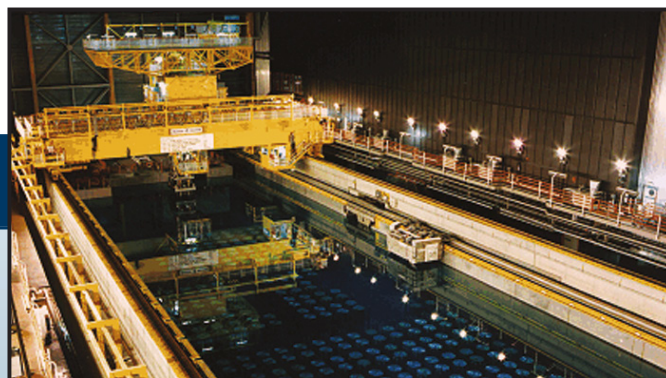

X Light

Subsea Bright Deepwater 24Vdc LED Panel Floodlight

TECHNICAL SPECIFICATIONS



Electrical	Voltage	24Vdc (12 to 48Vdc)
	Current at nominal voltage	4A
	Power	96W
	Connector	Contact for options
	Control method options	ON / OFF switch, analogue voltage, RS-485 serial input interface
Optical	Luminous flux	10,000 lumens
	Typical illuminance @ 1m	1340lx
	Lumen maintenance (70%)	>50,000 hours
	Colour temperature	6,500K
	Beam angle	80°
Mechanical	Housing / window	Aluminium-6082 T6 (hard anodised) / Optical Acrylic
	Dimensions	Ø103mm (LED Housing), 132mm height x 57.6mm width (exc. Connector)
	Weight in air / in water	1.56kg / 0.9kg
Environmental	Depth rating	6000m
	Storage temperature	-30°C to +70°C
	Operating temperature	-10°C to +40°C
	Shock	3 axis (operating), 30g peak, 6ms half sine pulse
	Vibration	3 axis (operating), 10g, 20 to 150Hz
	EMC emissions & immunity	BS EN 55015:2013+A1:2015 BS EN 61547:2009
	RoHS	Directive 2011/65/EU (RoHS compliant when fitted with RoHS compliant connector)

Product dimensions (for reference only)

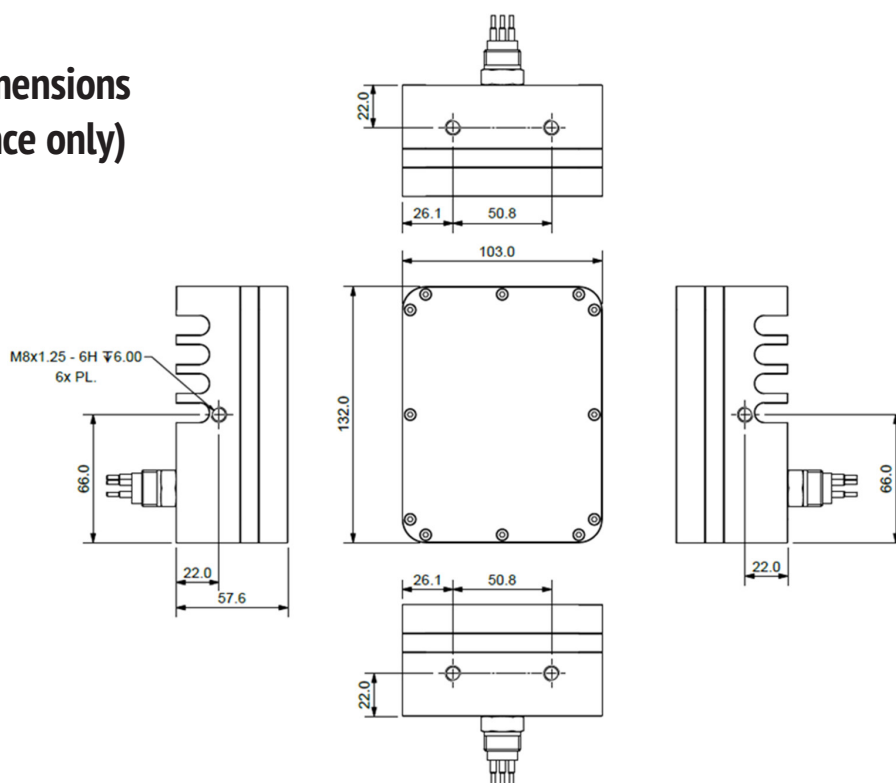

TELEDYNE MARINE
BOWTECH
Everywhere you look™

www.teledynemarine.com/bowtech

Tel. +44 (0)1224 772345

Email: bowtech@teledyne.com



Specifications subject to change without notice.
© 2022 Teledyne Bowtech. All rights reserved. PLD20325-3