

LED-K-IR-DC LED-N-IR-DC Underwater LED Infra-red Light



underwater **vision** specialists

Features

- Shock & Vibration Resistant
- 3,000 or 6,000 Metre Rating
- Wavelength 740 or 850nm
- Dimmable
- Low Operating Cost
- Auto Temperature Regulated



Description

The Bowtech Products LED-Infra-Red lamp is fitted with a cluster of Near IR LEDs, with a wavelength of either 740 or 850nm.

The LED has no fragile filaments, is highly shock resistant, robust, with exceptional longevity. The LED has an effective lifetime greater than 30,000 hours.

The lifetime allows an enormous "in-service" cost, saving over lamps with older LEDs.

The 3,000 metre rated housing is made from hard anodised aluminium, titanium and stainless steel, which all offer proven, corrosion resistance.

The light produced is ideal for non-intrusive observations of marine ecosystems.

Benefits of LED Lighting

No Fragile Filaments

Rugged Construction

Highly Shock and
Vibration Resistant

Enormous "In-service"
Cost Saving Over Incandescent Bulbs



© Bowtech Products Ltd 2014 All rights reserved.
Bowtech Products Ltd reserves the right to change the
above specifications without notice.

T +44 1224 772345
F +44 1224 772900

sales@bowtech.co.uk
www.bowtech.co.uk

Last updated 30th June 2014
Revision: 0

LED-K-IR-DC LED-N-IR-DC Underwater LED Infra-red Light



underwater **vision** specialists

Specification – LED-INFRA-RED-DC

ELECTRICAL

Input Power Requirement: 24Vdc, 1000mA

OPTICAL

Window/Lens: Acrylic 3,000m
Fused Quartz 6,000m
Typical Radiant Flux: 12W
Typical Wavelength: 740 or 850 nm
Dimming: 0-5Vdc, 0-10Vdc, Bipolar, RS-485
Lumen Maintenance (70%): 30,000 hours

ENVIRONMENTAL

Operating Depth: 3,000m or 6,000m
Storage Temperature: -30 to +70°C
Operating Temperature: -10 to +40°C (in water)
Housing Materials: Hard Anodized 6082-T6 Aluminium, Titanium, Stainless Steel

MECHANICAL

Length: 89mm (3.5in) Excluding Connector
Diameter: 76.0mm (3in) Front-end, 31.75mm (1.25in) Body
Lamp Type: Bowtech Products' LED Array
Weights in Air: Aluminium 0.460kg, Titanium 0.670kg, Stainless Steel 1.080kg
Weights in Water: Aluminium 0.240kg, Titanium 0.450kg, Stainless Steel 0.860kg
Mounts: Optional Mounting Bracket with a Variety of Thread Mounts
Typical Beam Angle: 80° to 50° Power Points
Standard Connector: MCBH3M
Optional Connectors: A Wide Range of Connectors

PART NUMBERING

LED- - - -IR-DC

DEPTH RATING		WAVELENGTH	
3,000m	K	740nm	740
6,000m	N	850nm	850



© Bowtech Products Ltd 2014 All rights reserved.
Bowtech Products Ltd reserves the right to change the above specifications without notice.

T +44 1224 772345
F +44 1224 772900

sales@bowtech.co.uk
www.bowtech.co.uk

Last updated 30th June 2014
Revision: 0

LED-K-IR-DC LED-N-IR-DC Underwater LED Infra-red Light



underwater **vision** specialists

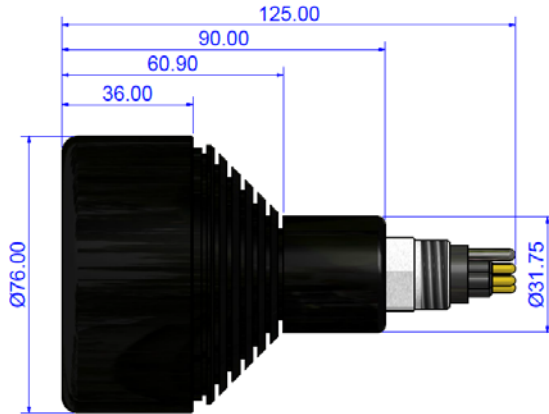

3,000m Option (K-Series)



6,000m Option (N-Series)

Standard Connector Options



MCBH3M



XSG-3-BCL

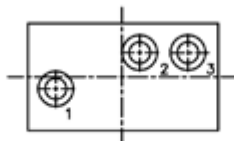

LPMBH-3-MP



BH-3-MP



MSAJ-3-BCR

Connector Options for RS-485 Control

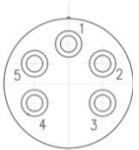

MCBH5M

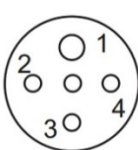

XSG-5BCL

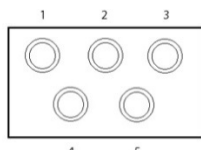

LPMBH-5-MP



BH-5-MP

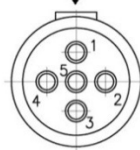

MSAJ-5-BCR

(connector face patterns not to scale)



© Bowtech Products Ltd 2014 All rights reserved.
Bowtech Products Ltd reserves the right to change the
above specifications without notice.

T +44 1224 772345
F +44 1224 772900

sales@bowtech.co.uk
www.bowtech.co.uk

Last updated 30th June 2014
Revision: 0